

PCB专用滤波器
PCB dedicated filter

PCB专用系列：PCB专用Series



PCB 专用系列：PCB专用 Series

特点和应用：Features and Applications

价格低廉, 安装方便, 可直接应用与PCB板上
Installation convenience, and can be directly applied on PCB with cheap price
滤波频率130MHZ以上时, 优于表面安装器件
Filter frequency 130MHZ above, the superior surface installed devices

适用于电信设备、线性电源放大器、中继器、医疗设备、遥感器、计算机等电子产品的滤波

Apply to telecommunications equipment, linear power amplifiers, repeaters, medical equipment, remote sensors, computers and other electronic products

订购信息：Ordering Information

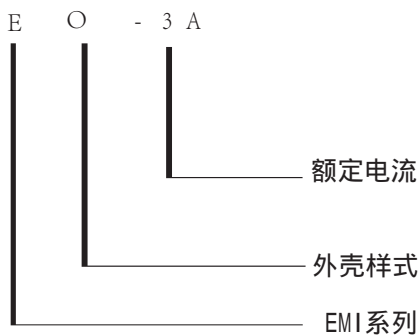

可选型号 Available Part Numbers

| 型号 Type ZYH- | 额定电流范围 Rated Current (A) | 绝缘电阻 Insulation Resistance | 端接方式 Terminal | |
|--------------------|--------------------------------|----------------------------------|------------------|---------|
| | | | 入Input | 出Output |
| EO | 1-10 | ≥ 300 | | |
| E03 | 1-10 | ≥ 300 | | |

规格：Specifications

每条线路对地的最大泄漏电流：
Maximum leakage current each Line to Ground：

| | E0 | E0 | E03 |
|------------------|-------|--------|--------|
| @ 250 VAC 50 Hz: | 0.5mA | ≤0.5mA | ≤1.5mA |

Hipot额定值（一分钟）：

Hipot rating (one minute):

| | |
|--------------------------------|----------|
| 线路对地： Line to Ground: | 1800VAC |
| 线对线： Line to Line: | 1500VDC |
| 工作电压： Rated Voltage (max.): | 250VAC |
| 工作频率： Operating Frequency: | 50/60HZ |
| 额定电流： Rated Current: | 0.5-10AA |

电路原理图Electrical Schematics

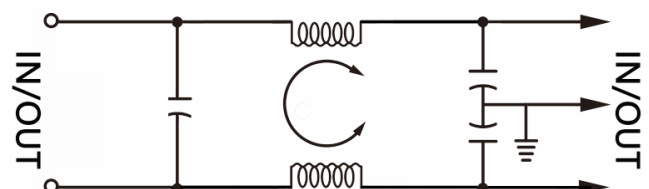

PCB专用滤波器
PCB dedicated filter

PCB专用系列 : PCB dedicated filter

E0外壳样式 : E0 Case Styles

样式1 : Case Styles One

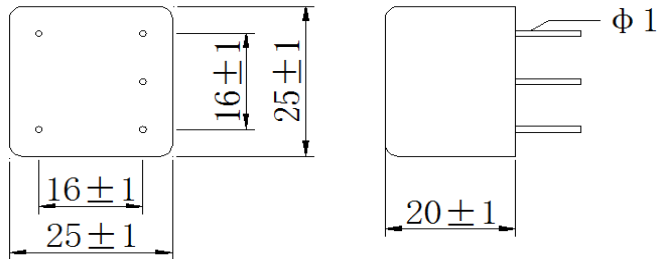

样式2 : Case Styles Two

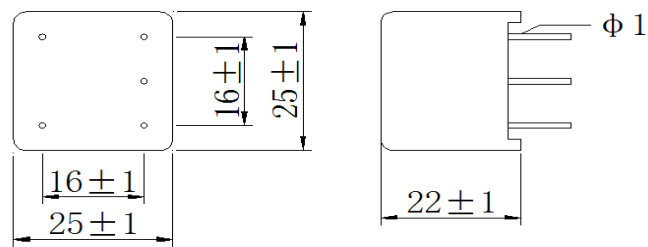

样式3 : Case Styles Three

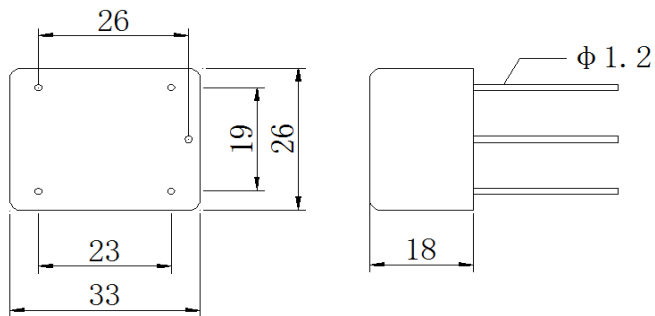

E03外壳样式 : E03 Case Styles

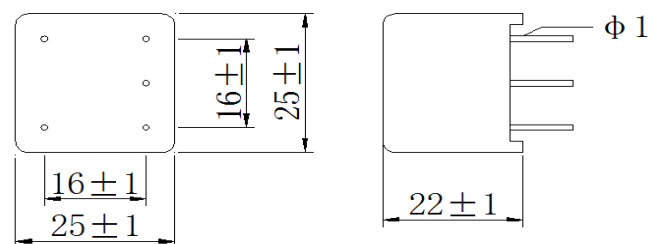

PCB专用滤波器
PCB dedicated filter

PCB专用系列 : PCB dedicated Series

性能参数

Performance Data

典型插入损耗

Typical Insertion Loss

在封闭的50欧姆系统中测量

Measured in closed 50 Ohm system

— 共模/不对称 (L-G)
 Common Mode / Asymmetrical (L-G)
 — 差模/对称 (L-L)
 Differential Mode / Symmetrical (L-L)

3A

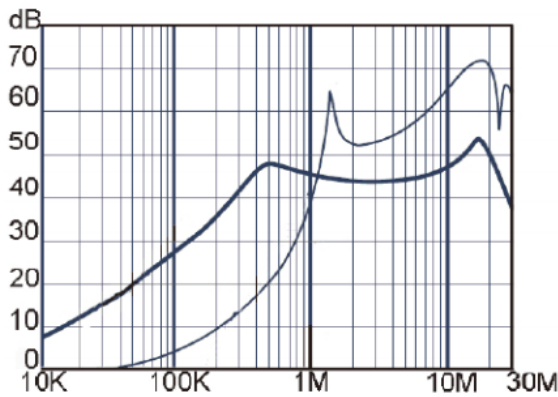

6A

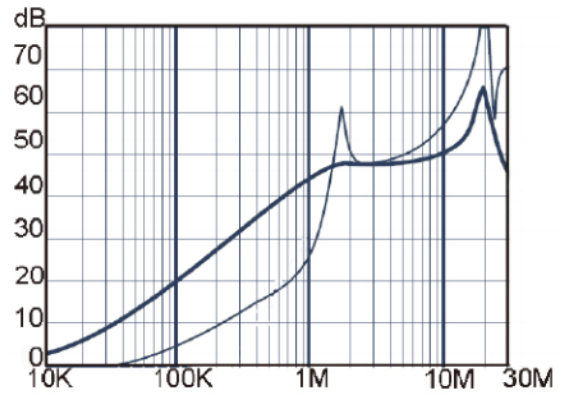

10A

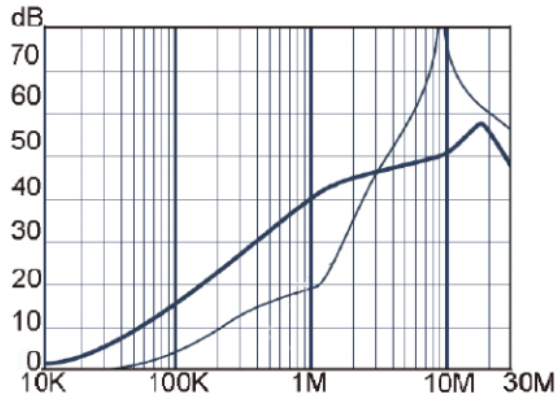

最小插入损耗 Minimum Insertion Loss

共模/不对称 (线对地)
Common Mode / Asymmetrical (Line to Ground)

差模/对称 (线对线)
Differential Mode / Symmetrical (Line to Line)

| Current Rating | Frequency – MHz | | | | | |
|------------------|-----------------|----|----|----|----|----|
| | .15 | .5 | 1 | 5 | 10 | 30 |
| VR Models | | | | | | |
| 3A | 5 | 34 | 43 | 45 | 50 | 38 |
| 6A | 5 | 44 | 60 | 65 | 65 | 60 |
| 10A | 5 | 44 | 45 | 48 | 55 | 48 |

| Current Rating | Frequency – MHz | | | | | |
|------------------|-----------------|----|----|----|----|----|
| | .15 | .5 | 1 | 5 | 10 | 30 |
| VR Models | | | | | | |
| 3A | 5 | 34 | 43 | 45 | 50 | 38 |
| 6A | 10 | 34 | 43 | 45 | 50 | 45 |
| 10A | 10 | 50 | 38 | 60 | 88 | 60 |